

Paslode Proline 250 Pump

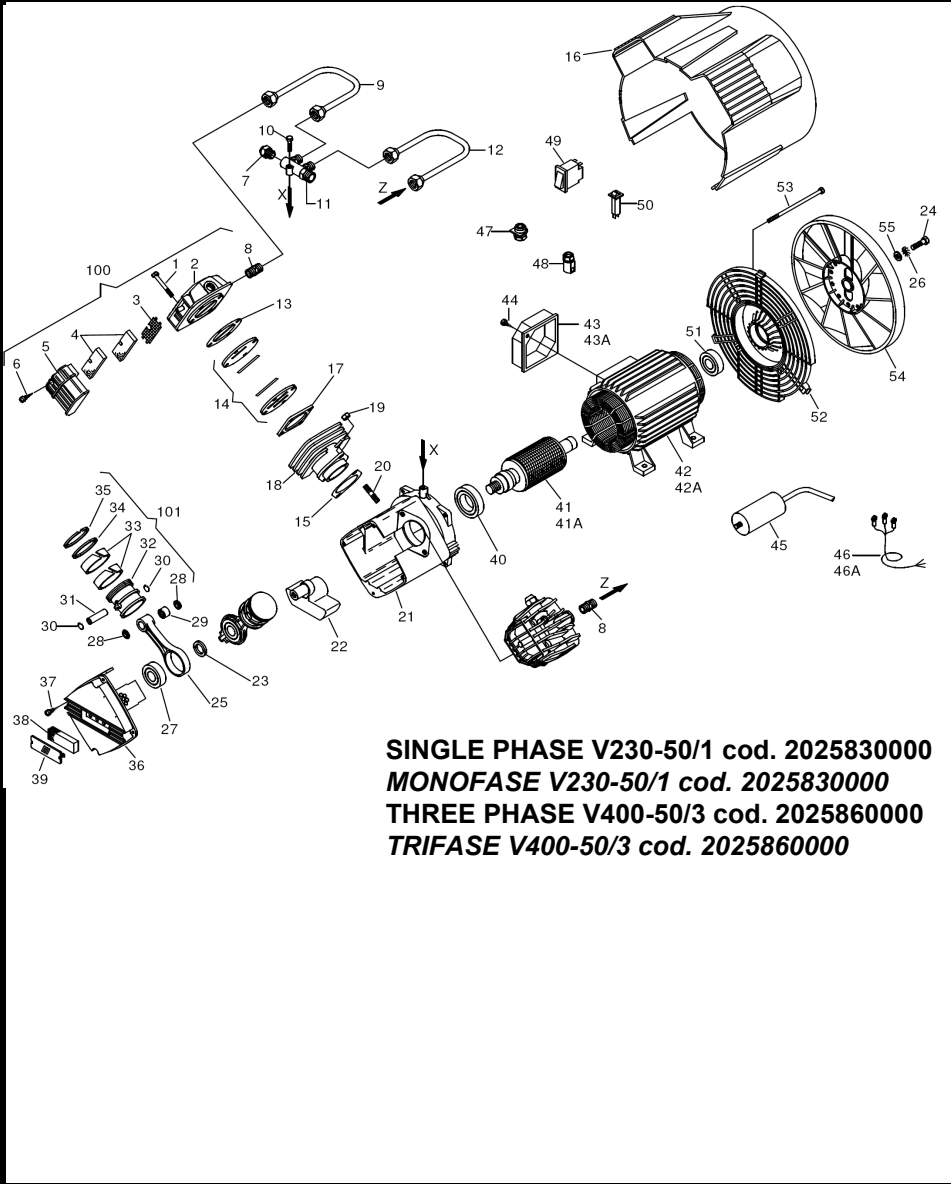

SINGLE PHASE V230-50/1 cod. 2025830000
MONOFASE V230-50/1 cod. 2025830000
THREE PHASE V400-50/3 cod. 2025860000
TRIFASE V400-50/3 cod. 2025860000

REF.	CODE	QT	DESCRIPTION	REF.	ITW CODE	QT
1	7011220000	8	Screw - Vite T.E. M6x40 UNI 5737		151328	
2	7570090000	2	Head - Testa		151332	
3	7458340000	2	Filter plate - Piastrina filtro		151333	
4	7210010000	2	Filtering element - Elemento filtrante		151334	
5	7210180000	2	Intake filter - Filtro aspirazione		151335	
6	7012100000	2	Screw - Vite ø 3.9x16 B UNI 6954		151329	
7	7196020000	1	START valve - Valvola START (Monofase)		151336	
7A	7090070000	1	Plug - Tappo 39173 M (Trifase)		150802	
8	7081100000	2	Joint - Raccordo		151337	
9	7237020000	1	Tube sx. - Tubo sx.		151338	
10	7010120000	1	Screw - Vite T.C.C.E. M6x25 UNI 5931		151330	
11	7089950000	1	Manifold - Collettore		151339	
12	7237010000	1	Tube dx. - Tubo dx.		151340	
13	7078580000	2	Head gasket - Guarnizione testa		151341	
14	7459510000	2	Valve plate unit - Gruppo Piastra Valvole		151342	
15	7078570000	2	Cylinder/motor gasket - Guarnizione cilindro/motore		151343	
16	7150370000	1	Housing - Carenatura		151344	
17	7078160000	2	Cylinder/Valve plate gaskets - Guarnizioni cilindro/piastra valvole		151345	
18	7575350000	2	Cylinder - Cilindro		151346	
19	7020070000	4	Nut - Dado M8 UNI 5587		151347	
20	7015480000	4	Stud bolt - Prigioniero M8x30 UNI 5911		151348	
21	5070180008	1	Carter - Carter		151349	
22	5040980008	1	Crank lever - Manovella		151350	
23	7031190000	1	Ring - Anello		151351	
24	7011090000	1	Screw - Vite T.E. M8x20 UNI 5739		151331	
25						
28-29	4190320000	2	Con rod unit - Gruppo biella		151352	
26	7031010000	1	Washer - Rondella ø 8 UNI 3703		151353	
27	7060140000	2	Bearing - Cuscinetto 6204-2RS2-C3-HT22		151354	
30	7041010000	4	Ring - Anello		151356	
31	7050050000	2	Piston pin - Spinotto		151357	
32	7220070000	2	Piston - Pistone		151358	
33						
34-35	4080040000	2	Piston rings - Kit segmenti		151359	
36	7650010000	1	Carter cover - Coperchio carter		151446	
37	7012180000	5	Screw - Vite		151447	
38	7181190000	1	Plug - Tappo a pressione		151449	
39	7078440000	1	Cover gasket - Guarnizione coperchio carter		151450	
40	7060050000	1	Bearing - Cuscinetto 6007 2RS		151451	
41	4280780000	1	Single phase rotor - Indotto monofase		151453	
41A	4280790000	1	Three phase rotor - Indotto trifase		151454	
42	4013420000	1	Motor - Motore V230-50/1		151455	
42A	4011340000	1	Motor - Motore V400-50/3		151456	
43	7382130000	1	Single phase cover - Coperchio monofase		151457	
43A	7382350000	1	Three phase cover - Coperchio trifase		151458	
44	7012020000	2	Screw - Vite ø 3.9x12.7 UNI 6954		151448	
45	7310380000	1	Capacitor - Condensatore 40 µF		151459	
46	7329900000	1	Single phase cable - Cavo monofase		151460	
46A	7329870000	1	Three phase cable - Cavo trifase		151461	
47	7501060000	1	Stretch eliminator - Bloccacavo		151462	
48	7501050000	1	Stretch eliminator - Bloccacavo steab		151463	
49	7410460000	1	3ph. thermal protection - Termica trifase		151464	
50	7410750000	1	1ph. thermal protection - Termica monofase		151465	
51	7060090000	1	Bearing - Cuscinetto 6204 2RS		151452	
52	7640010000	1	Cover - Calotta		151467	
53	7015100000	4	Tension rod - Tirante		151468	
54	7200340000	1	Fan - Ventola		151469	
55	7038020000	1	Washer - Rondella ø 8x30x3		151470	
56	7090080000	2	Plug - Tappo		151471	
57	7410460000	1	3ph. thermal protection - Termica trifase		151464	
					0	
100	4020870000	2	Head Unit - Gruppo Testa		151472	
101	4191011000	2	Set Con rod/Piston - Kit Biella/Pistone		151473	